

OMTF series 11

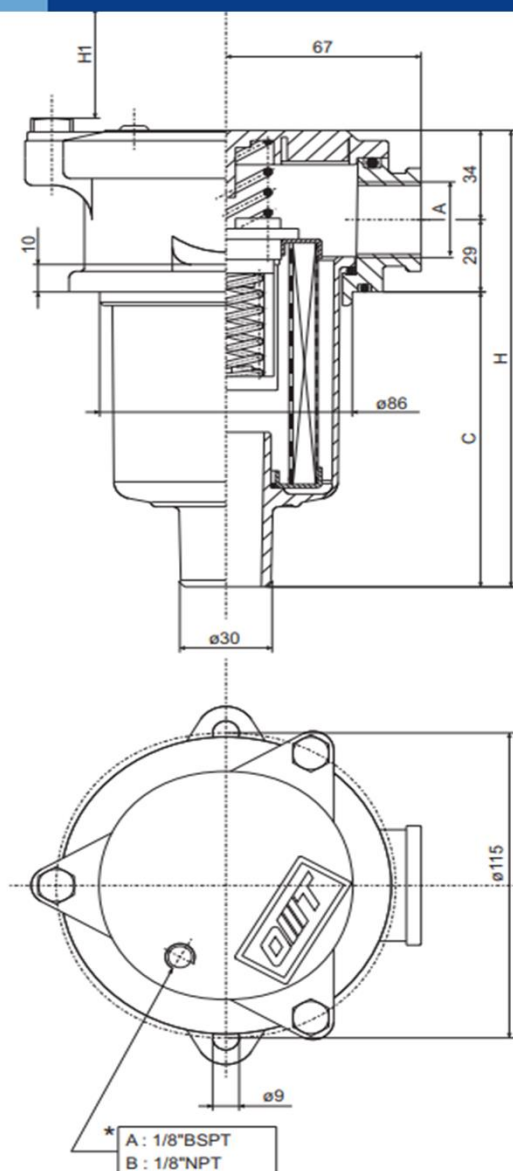

ATTACCHI CONNECTIONS

Tipo / Type	A
1	1/2" BSP
2	3/4" BSP
3	1" BSP
4	1/2" NPT
5	3/4" NPT
6	1" NPT
7	SAE8 - 3/4"-16UNF
8	SAE12-1 1/16"-12UN
	SAE16-1 5/16"-12UN

LUNGHEZZE LENGTHS

Tipo / Type	C	H	H1
1	92	155	130
2	150	200	175

PORTATE CONSIGLIATE RECOMMENDED FLOWS

OMTF	Elemento filtrante Filter element	Portata (L/min) Flow (L/min)	Peso (Kg) Weight (Kg)
111	C10/C25	81	0,715
111	F03	31	0,715
111	F06	34	0,715
111	F10	39	0,715
111	F25	58	0,715
111	R60/R90	81	0,715
112	C10/C25	100	0,770
112	F03	37	0,770
112	F06	42	0,770
112	F10	55	0,770
112	F25	92	0,770
112	R60/R90	100	0,770

* La tipologia di filettatura del foro per indicatore deve essere specificata nel codice di ordinazione

* Hole threading type for the indicator must be specified in the order code

Flows have been calculated just in order to obtain a pressure drop $\Delta p \leq 40.000 \text{ Pa}$ (0.4 bar) with mineral oil kinematic viscosity 30 cSt and 860 kg/m³ density. (See remarks on page 09)

OMTF serie/series 11

ΔP CORPI / ΔP HOUSINGS

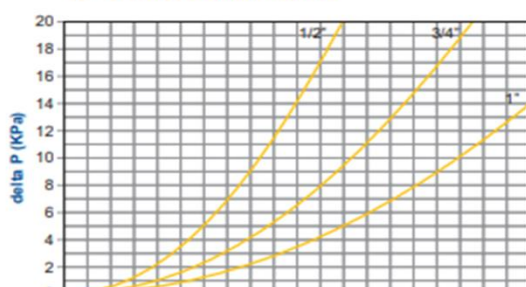

BY-PASS / BY-PASS

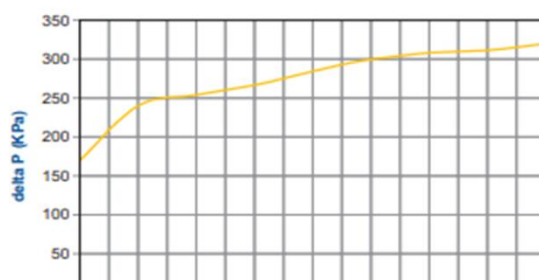

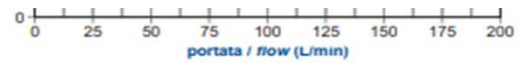
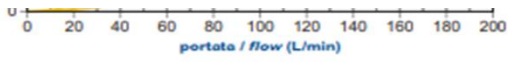

ΔP ELEMENTI

tipo CR11 1 series

ΔP ELEMENTS

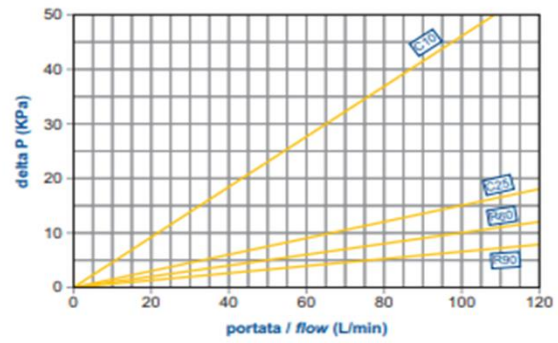
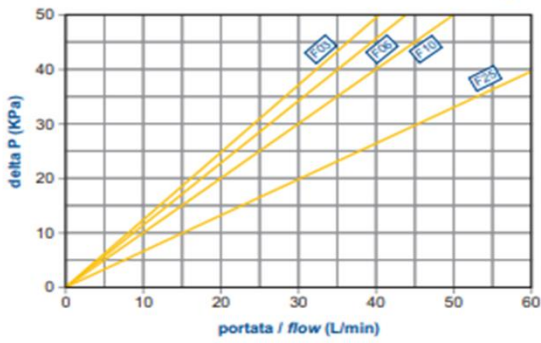

ΔP ELEMENTI

tipo CR11 2 series

ΔP ELEMENTS

