

**TIPDI DI REGOLAZIONE**

**REGULATION TYPE**

	<b>H</b>	VALV CON CHIAVE REGOLABILE (ADJUSTABLE) HEXAGONAL HEAD SCREW
	<b>K</b>	PERNO KNOB
	<b>C</b>	PERNA CON CAPPICCIO COVER CAP
	<b>I</b>	INREGOLABILE NOT ADJUSTABLE

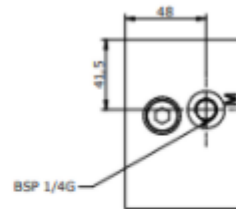

**E 10 - 09 - - - -**

**S** = STEEL  
**A** = ALUMINIUM

**12** = BSP 1/2G  
**34** = BSP 3/4G

**0** = WITHOUT RELIEF VALVE (PLUGGED CAVITY)  
**1** = WITH RELIEF VALVE  
**2** = RELIEF VALVE READY

**0** = WITHOUT RELIEF VALVE  
**H** = HEXAGONAL HEAD SCREW  
**K** = KNOB  
**C** = COVER CAP  
**I** = NOT ADJUSTABLE

**0** = WITHOUT RELIEF VALVE  
**1** = 5-55 bar  
**2** = 25-110 bar  
**3** = 75-250 bar