

SNP2NN/...X6SA



SKUPINA 2

Technické dáta

		Veľkosť								
		4,0	6,0	8,0	011	014	017	019	022	025
Objem	ccm	3,9	6,0	8,4	10,8	14,4	16,8	19,2	22,8	25,2
Maximálny tlak	bar	280	280	280	280	280	280	230	200	175
Menovitý tlak		250	250	250	250	250	250	210	180	160
Maximálne otáčky	min-1	4000	4000	4000	4000	3500	3000	3000	3000	3000
Hmotnosť	kg	2,30	2,40	2,50	2,70	2,90	3,00	3,10	3,20	3,30
Prietok pri 1400 ot/min	l/min	4,91	7,56	10,58	13,61	18,14	21,17	24,19	28,73	31,75
Teoretický prietok pri max otáčkach	l/min	15,60	24,00	33,60	43,20	50,40	53,40	57,60	68,40	75,60

Montážna príruka

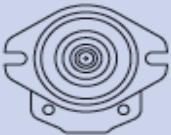
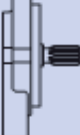
Hriadel'

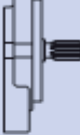
06		SAE A pilot Ø 82,55 + 2 otvory	SA		Drážkovaný hriadel' SAE J498-9T-16/32
A6		SAE A pilot Ø 82,55 + 2 otvory + tesnenie	SA		Drážkovaný hriadel' SAE J498-9T-16/32

Porty

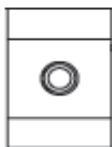
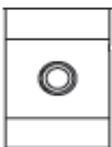
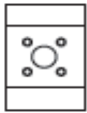
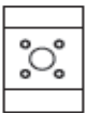
Sanie			Výtlak		
F4		1/2 GAS	F4		1/2 GAS
B7		20x40xM6	B5		15x35xM6

Rozmery

	4,0	6,0	8,0	011	014	017	019	022	025
A	43,25	45,00	45,00	49,00	52,00	52,00	56,00	59,00	59,00
B	90,00	93,50	97,50	101,50	107,50	111,50	115,50	121,50	125,50

06SA (SNP2NN)

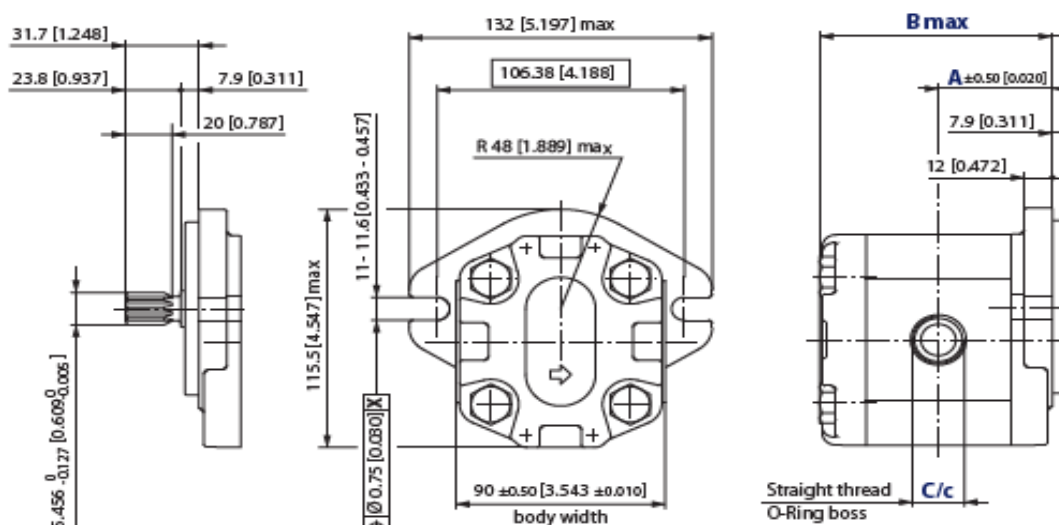

Splined:
SAE J496-9T-16/32DP
Flat root side fit
(circular tooth thickness
0.127 mm [0.005] less than
standard class 1 fit)

Hireco
TECHNIK